

TOP VIEW

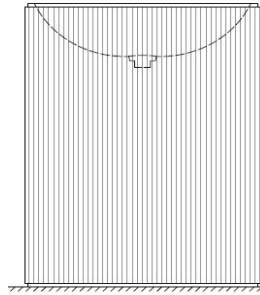

FRONT VIEW

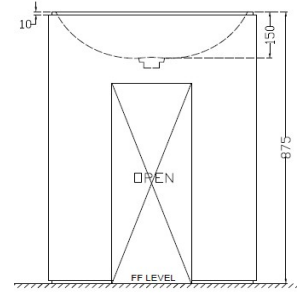

BACK VIEW

GENERAL INFORMATION

Product Code	NVS-MBT-515401
Brand	Artize
Colour	Banswara White With Light Veins
Type	Floor Standing Basin
Material	Banswara Stone

PRODUCT SPECIFICATION

Product Dimension	600x400x875 mm
Basin Inner Dimension	550x350x150 mm
Product Net Weight	215 kg.
Product Gross Weight	235 Kg
Packaging Dimension	760x560x1100 mm
Outlet	Vertical
Technical Details:	Internal diameter of outlet hole dia. $\varnothing 45 \pm 2/-1$ mm Horizontal distance between the Bowl edge and the centre line of the waste outlet hole ≤ 220 mm

PRODUCT FEATURES

Product Features	<p>Crafted from premium natural Banswara stone Unique natural veining makes every basin exclusive Long lasting strength, carved from a single block of marble Strong, durable, easy to clean - resistant to stains Luxurious statement piece for premium bathrooms Minimal yet luxurious fluted design</p>
------------------	---

CARE AND CLEANING GUIDELINES

- Vitreous china sanitary ware products are fragile in nature and need to be handled with care (to avoid personal injury) at all times during its storage, handling, installation and use thereafter.
- The product is heavy and it is recommended that two persons hold it while it is being fixed.
- Carefully inspect the new product for damage before installation. Recommended to inspect the sanitaryware with wooden Hammer.
- Risk of product damage. Over tightening may cause breakage or chipping of vitreous china. Recommended to use hard rubber & nylon spacer in between ceramic & metal fixtures.
- Risk of external leakage. Do not lift or rock the bowl after placement.
- Always test your cleaning solution on an inconspicuous area on the product before applying it to the entire surface.
- Do not allow cleaners to sit or soak on the product.
- Use a soft, dampened sponge or cloth to clean. Never use abrasive material like a bristle brush or scouring pad.
- Wipe surfaces clean and rinse completely with water immediately after applying cleaners.
- Clean Chrome, stainless steel surfaces once a week. Do not use cleaners containing chloride on chrome, stainless steel. If used, rinse the surface immediately to prevent corrosion.
- Wherever chrome plating is used on the products, use only warm water to clean and then dry with a soft cloth.
- Recommended to use Genuine Accessories.

QUALITY MANAGEMENT SYSTEM - ISO 9001

