

PRODUCT DETAILS

|                    |  |              |                                   |
|--------------------|--|--------------|-----------------------------------|
| Manufacturer :     | Artize   | Type:        | Intelligent Toilet - Wall Hung WC |
| Range              | Intelligent Artize   | Flush valves | 6.0L                              |
| Colour:            | White  | Material:    | White PP + Ceramic Bowl           |
| Outlet             | Vertical   | BOM doc.NO.  | ASW/09/2019/52                    |
| Technical Details: | Internal diameter of inlet hole dia. $\varnothing 55 \pm 3$ mm   |              |                                   |
|                    | External diameter of outlet hole dia. $\varnothing 100 \pm 5$ mm |              |                                   |

ARTICLE NAME: WALL HUNG WC



TECHNICAL DIMENSIONS

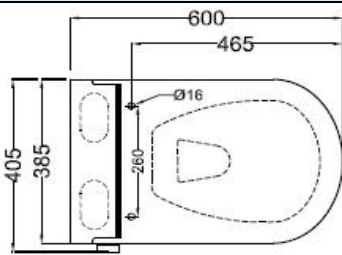

TOP VIEW

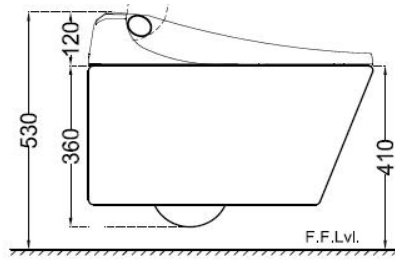

SIDE VIEW

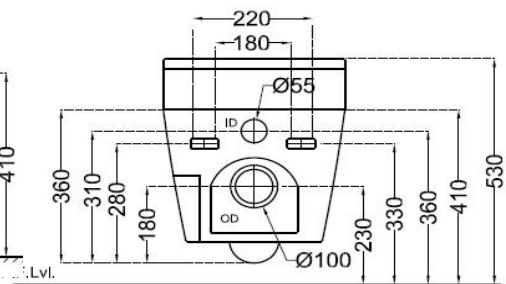

BACK VIEW

PRODUCT SPECIFICATION

|                                |                                 |                      |  |
|--------------------------------|---------------------------------|----------------------|--|
| Rated supply                   | 220v-240v-50-60Hz               | Dimension            | 400x600x480 mm   |
| Rated power                    | 1250W 1300W                     | Net Weight           | 40   |
| Water connection cross section | Water pipe supply,G3/8thread    | Wash Function        |  |
| Flushing water capacity        | Dual Flushing - 3/6 LPF(Manual) | Anal shower flow     | 350-1000m l/ Min   |
| Outlet Distance Floor Lvl.     | 230 c/c                         | Lady shower flow     | 350-1000m l/ Min   |
| Installation Mode              | Wall hung WC                    | Heating              | Instant heating  |
| Inlet mode                     | Connect water pipe              | Safety device        | Anti-dry/burn protection,relief valve,presure stabilization valve,thermal fuse |
| Flushing mode                  | Fall to rush                    | Toilet Seat Heating  |  |
| Flushing way                   | Manual flush/ Auto flush.       | General heater power | 35W  |
| Drainage way                   | wall exhaust                    | Safety device        | Temperature controller ,NTC and thermal fuse                                   |
| Water pressure range           | 0.07MPa-0.75Mpa                 | Dry                  |  |
| Operating temperature range    | 46.4-95 F                       | wind speed           | $\leq 4$ m/s   |
| Black flow prevention          | Anti siphon,Backflow prevention | General heater power | 200W   |
| Seat cover                     | White PP soft close seat cover  | Safety device        | Temperature controller ,NTC and thermal fuse                                   |

ACCESSORIES PROVIDED

|   |                  |
|---|------------------|
| Electronic PP Soft Close Seat Cover                 | IAS-WHT-79103SPP |
| Remote For ZSZ-WHT-79101SPP                         | ZPS-WHT-IA03     |
| Seat Installation Fixing screw For ZSZ-WHT-79101SPP |                  |

ACCESSORIES RECOMMENDED

|                   |                     |
|-------------------|---------------------|
| Control plate     | ACP-ROG-5012501     |
| Concealed cistern | APC-WHT-5012500WSAF |



CERTIFICATION

Compliance : EN 997 :2012+A1:2015



DISCLAIMER: Our every effort has been made to ensure factual accuracy, the information presented subject to changes due to requirements in different sites, markets and/ or countries. All dimensions are in mm (Tolerance  $\pm 5$  MM). Jaquar reserves the right to make the necessary amendments at any time without prior notice.